



Vitrina expositora helados / Gelato display case / Vitrine d'exposition pour glace

MODELO MODELE MODÈLE	 VCB 12 UH	 VCB 15 UH	 VCB 18 UH
Precio Price Prix			
Medidas/Measures/ Mesures (mm) Sin costados/Without sides/Sans joues	1250 x 1115 x 1320 mm.	1562 x 1115 x 1320 mm.	1875 x 1115 x 1320 mm.
Temperatura Temperature (°C) Température	-15°C/-18°C		
Clase Climática Climatic class (°C) Classe climatique	7 / 35°C		
Tensión/Frecuencia Electrical data Tension électrique	230V/1ph/50Hz		
Controlador Controller Régulateur	Digital		
Material Matériel (EXT/INT)	Acero plastificado / Plastified galvanised steel / Acier galvanisé plastifié Plano exposición / Exhibition plan / Plan d'exposition: Inox Aisi 304		
Aislamiento Isolation (mm)	40kg/m ³ / Free CFC's / Zero ODP-GWP		
Capacidad Capacity (L) Capacité	182	228	274
Superficie exposición Surface exhibition (m ²) Surface d'exposition	0,96	1,20	1,49
Compresor Compressor (HP) Compresseur	1 1/4	1 1/4 + 1	1 1/4 + 1
Bandejas Shelving Bacs	8 / 14	10 / 16	14 / 20
Costados [2] Sides [2] (mm) Joues [2]	30 +30		
Sistema de frío Cooling System Système de froid	Ventilado / Ventilated / Ventilé		
Desescarche Defrost Dégivrage	Gas caliente / Hot gas / Gaz chaud		
Evaporación Evaporation Évaporation	Ventilado / Ventilated / Ventilé		
Potencia Power (W) Puissance	1250	1570	1640
Potencia frig. Cooling capacity (W A -10°C) Puissance Frig.	-		
Consumo Consumption (kWh/ 24h) Consommation	19,7	28,9	30,8
Refrigerante Refrigerant Gaz	R-290		
Opcional Optional Options	230v/1ph/60 Hz		
	Combinación de bandejas / Tray combinations / Combinaisons de bacs (501X36) x 8uds. (501X32) x 14uds. (501X36) x 10uds. (501X32) x 16uds. (501X36) x 14uds. (501X32) x 20uds.		
	Puertas correderas traseras / Rear sliding doors / Portes arrière coulissantes PUEVCB12CT	Puertas correderas traseras / Rear sliding doors / Portes arrière coulissantes PUEVCB15CT	Puertas correderas traseras / Rear sliding doors / Portes arrière coulissantes PUEVCB18CT

NEW

Serie / Series / Série **CORAL**

+Info: www.infrico.com



VCB15UH

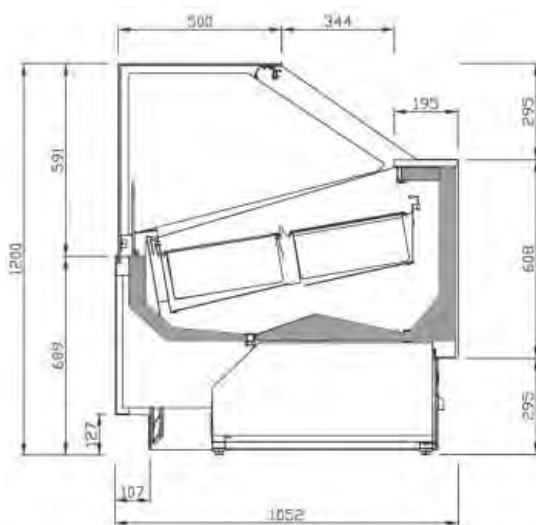

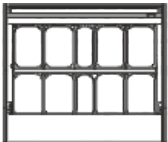
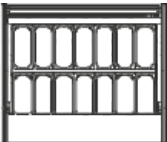
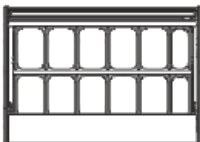
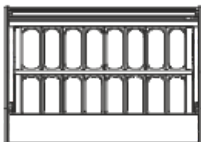
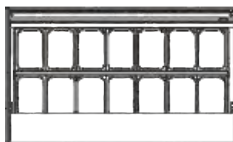
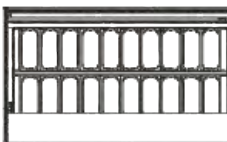
(501X36) x 8 uds.	(501X32) x 14 uds.	(501X36) x 10 uds.	(501X32) x 16 uds.	(501X36) x 14 uds.	(501X32) x 20 uds.
					
8	14	10	16	14	20

